

Dimension: (UNIT:mm)

A	15.0 ± 0.4
B	7.5 ± 0.15
C	4.65 ± 0.15
D	5.5 ± 0.25
E	11.0 ± 0.35
F	5.3 ± 0.15
G	2.4 ± 0.1
H	

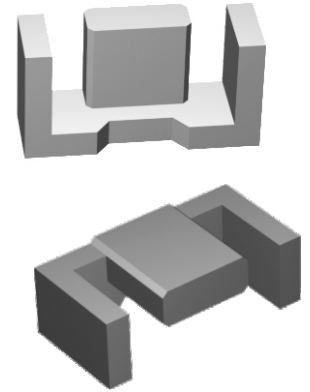
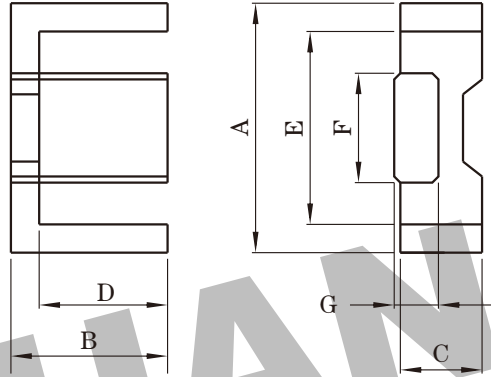

**Test conditions**

AL: F=1.0KHz U=0.3V N=10Ts

**Effective parameter**

C1(mm) <sup>-1</sup>	Ae(mm <sup>2</sup> )	Le(mm)	Ve(mm <sup>3</sup> )	Weight(g)
2.27	15.0	34.0	510	≈1.4

Core sets of high permeability grades.  
Clamping force for Al measurements, 10+/-5N

**Core sets**

Clamping force for Al measurements, 20+/-5N

Grade	AL (nH)	μe	AIR GAP μm	Type number
H5K	3600+40/-30%	≈6500	≈0	EFD15-H5K

Grade	AL (nH)	μe	AIR GAP μm	Type number
P3	63 ± 5%	≈ 115	≈ 400	EFD15-P3
	100 ± 8%	≈ 180	≈ 220	EFD15-P3
	160 ± 10%	≈ 290	≈ 120	EFD15-P3
	950 ± 25%	≈ 1700	≈ 0	EFD15-P3
P4	63 ± 5%	≈ 115	≈ 400	EFD15-P4
	100 ± 8%	≈ 180	≈ 220	EFD15-P4
	160 ± 10%	≈ 290	≈ 120	EFD15-P4
	950 ± 25%	≈ 1700	≈ 0	EFD15-P4
HQ2KA	850 ± 25%	≈ 1520	≈ 0	EFD15-HQ2KA
HQ2K	63 ± 5%	≈ 115	≈ 400	EFD15-HQ2K
	100 ± 8%	≈ 180	≈ 220	EFD15-HQ2K
	160 ± 10%	≈ 290	≈ 120	EFD15-HQ2K
	780 ± 25%	≈ 1400	≈ 0	EFD15-HQ2K
P5	830 ± 25%	≈ 1130	≈ 0	EFD15-P5

**Properties of core sets under power conditions**

Grade	B (mT) at		Core loss (w) at		
	H=250 A/m F=25KHz T=100 °C	F=100 KHz B=100mT T=100 °C	f=100 KHz B=200mT T=100 °C	F=400 KHz B=50mT T=100 °C	F=500 KHz B=50mT T=100 °C
P3	≥ 320	≤ 0.057	-	-	-
P4	≥ 320	≤ 0.045	≤ 0.28	-	-
HQ2KA	≥ 340	≤ 0.035	≤ 0.22	≤ 0.09	≤ 0.19
HQ2K	≥ 315	≤ 0.06	-	≤ 0.1	-
P5	≥ 300	-	-	≤ 0.05	≤ 0.06

**Properties of core sets under power conditions (continued)**

Grade	B (mT) at		Core loss (w) at		
	H=250 A/m F=25KHz T=100 °C	F=500 KHz B=100mT T=100 °C	F=1.0 Mhz B=30mT T=100 °C	F=1.0MHz B=50mT T=100 °C	F=3.0MHz B=10mT T=100 °C
P3	≥ 320	-	-	-	-
P4	≥ 320	-	-	-	-
HQ2KA	≥ 340	-	-	-	-
HQ2K	≥ 315	-	-	-	-
P5	≥ 300	≤ 0.5	-	-	-

**Note:**

- 1: Document is the property of FUAN Inc & is not allow to be duplicated without authorization
- 2: RoHS compliant.